



16867

PALM PLAZA

RETAIL SPACE

MIAMI LAKES, FLORIDA 33015

16867 NW 67TH AVENUE

// PROPERTY OVERVIEW

SHIMA



SPACE AVAILABLE

1,750 SF retail space.
Pylon signage available



UPGRADES

Property upgrades totaling \$1.3 million, including new paint, landscaping, parking lot and façade renovations



LOVED BY LOCALS

Healthy balance of daytime and night time traffic



NEIGHBORS

Strong mix of local and national tenants with many in the top 10% nationwide. Join Navarro Pharmacy, Skechers, MDNow, and McDonald's



For retail leasing information, please contact:

MINDY MCILROY • mmcilroy@terranovacorp.com • 305.970.6344

LAUREN ROBBINS • lrobbins@terranovacorp.com • 757.581.2766

16867 NW 67TH AVENUE

SITE PLAN

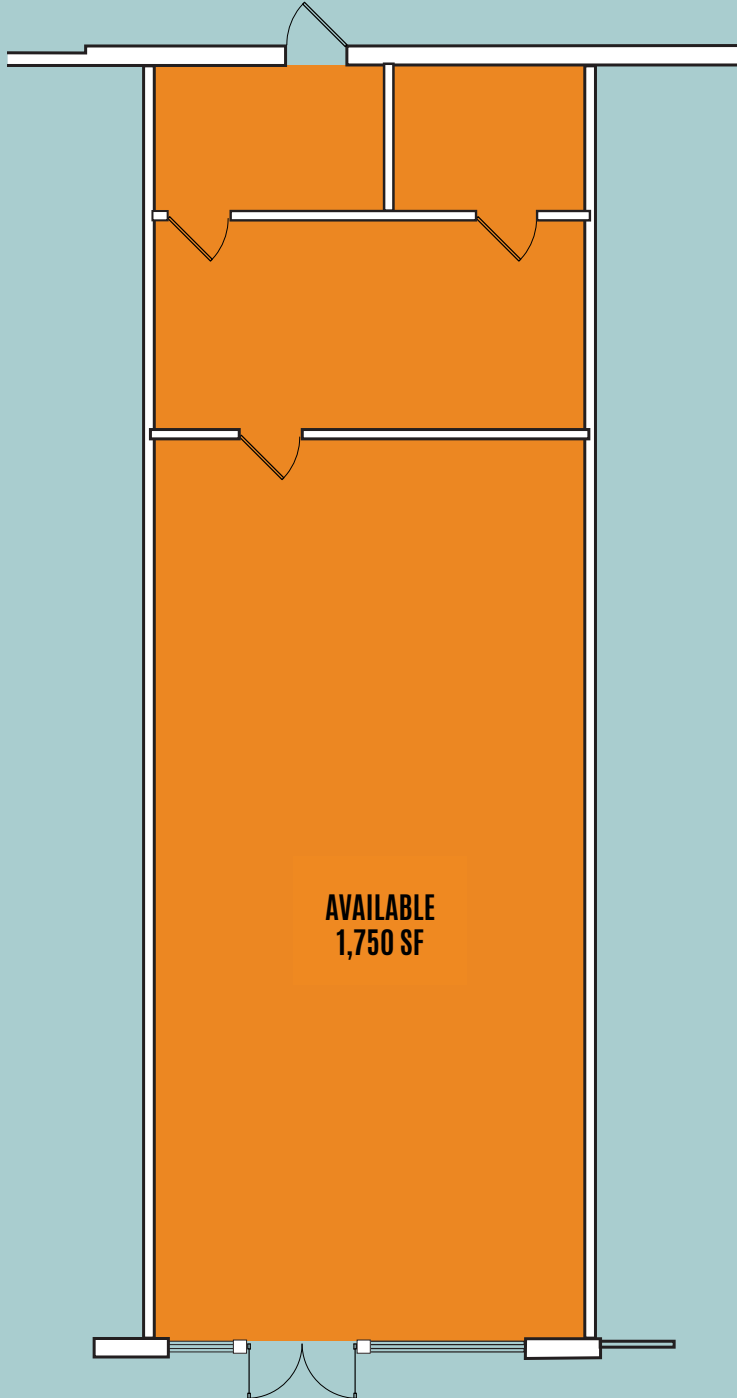

 =SUBJECT



For retail leasing information, please contact:

MINDY MCILROY • mmcilroy@terranovacorp.com • 305.970.6344

LAUREN ROBBINS • lrobbins@terranovacorp.com • 757.581.2766